

Head Office:
Dixon Kelley Estate Agents
1 Penn Court
Station Road, West Moors
Dorset. BH22 0JJ

Telephone: 01202 877511

DORSET PARK HOMES

DRAFT

www.dorsetparkhomes.com

65 Selwood Park, Weymans Avenue, Kinson, Bournemouth. BH10 7JU



Well Presented 22' Wide Park Home

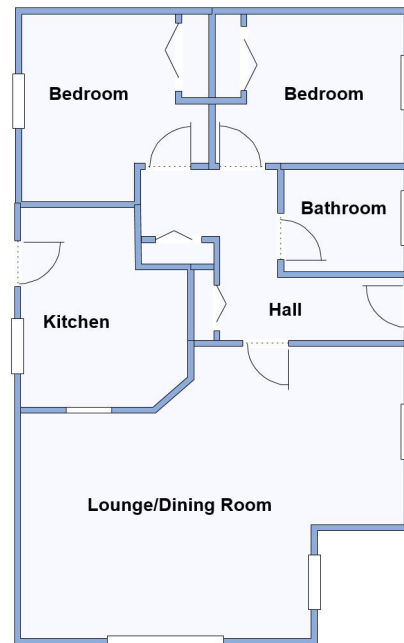

This drawing has been prepared for diagrammatic purpose only. Not to scale

2 Bedroom Park Home approx 35' x 22'

Accommodation & approximate room dimensions:

- Countryhomes 'Kingsbridge' Park Home circa 2015
- Entrance Hall
- Lounge/Dining Room: approx 21'5" x 16' max. Feature fireplace. 2 bay windows.
- Kitchen: approx 11' x 9' max. Range of base & wall units. Built-in oven, hob & hood. Space for washing machine & dishwasher. Integrated fridge/freezer. Cupboard housing combination gas boiler. Door to garden.
- Bedroom 1: approx 10'4" x 10'2". Fitted wardrobes & dresser unit.
- Bedroom 2: approx 10'4" x 8'2". Fitted wardrobes.
- Bathroom: Panelled bath with thermostatic shower & screen fitted. Pedestal wash basin & WC. Chrome heated towel rail.
- Gas Central Heating (system untested)
- PVCu Double-Glazing
- Parking on Plot
- Small Garden. Concrete Shed.
- Age restriction 50+. 1 Pet Considered
- Popular, well maintained Residential Park close to local amenities & with easy access to Bournemouth & Poole.

Good location close to amenities



Kitchen



Lounge/Dining Room



Lounge/Dining Room

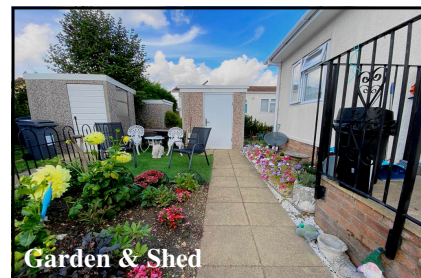

Garden & Shed

Price £175,000

VIEWING STRICTLY BY APPOINTMENT WITH THE VENDOR'S AGENT Dorset Park Homes 01202 877511

IMPORTANT NOTE: These particulars are believed to be correct but their accuracy is not guaranteed. They do not form part of any contract. Nothing in these particulars shall be deemed to be a statement that the property is in good structural condition or otherwise, nor that any of the services, appliances, equipment or facilities are in good working order or have been tested. Purchasers should satisfy themselves on such matters prior to purchase Ref.W05117

Pitch Fee: Approx £260 per month
Subject to Annual Review
Council Tax Band: 'A'

Tenure: 1983 Mobile Homes Act Agreement

The recommended specialist in Park Home sales
Proprietor: Simon Dixon

