

Head Office:
Dixon Kelley Estate Agents
1 Penn Court
Station Road, West Moors
Dorset. BH22 0JJ

Telephone: 01202 877511

DORSET PARK HOMES

DRAFT

www.dorsetparkhomes.com

12a Holton Heath Park, Wareham Road, Holton Heath, Poole. BH16 6JS



Beautifully Presented Park Home

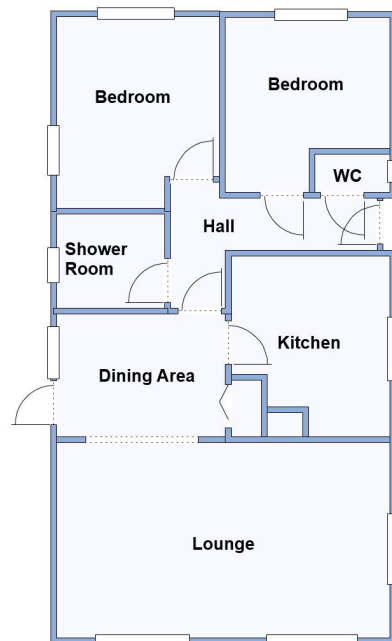

This drawing has been prepared for diagrammatic purpose only. Not to scale

2 Bedroom Park Home approx 36' x 20'

Accommodation & approximate room dimensions:

- Hall: Cloaks cupboard
- Cloakroom: Wash basin & WC. Heated towel rail.
- Lounge: approx 19'3" x 11'5". Feature fireplace. Vaulted ceiling. Wonderful field views.
- Dining Area: approx 9'9" x 7'1". Door to garden. Cupboard housing combination gas boiler.
- Kitchen: approx 10'3" x 9'2" max. Range of floor & wall cupboards. Space for washing machine & tall fridge/freezer. Cooker point.
- Bedroom 1: approx 11'2" x 9'5".
- Bedroom 2: approx 10' x 9'5".
- Shower Room: Large shower cubicle, WC, Vanity wash basin & Chrome heated towel rail.
- New Carpets Throughout.
- Gas Central Heating (system untested)
- PVCu Double-Glazing
- Newly laid Patio Garden with sunny aspect.
- Parking on Plot
- Age Restriction 50+ 1 Cat Permitted. No Dogs
- Small, popular Residential Park near to local amenities and between Wareham & Poole.

PRICE £125,000

VIEWING STRICTLY BY APPOINTMENT WITH THE VENDOR'S AGENT Dorset Park Homes 01202 877511

IMPORTANT NOTE: These particulars are believed to be correct but their accuracy is not guaranteed. They do not form part of any contract. Nothing in these particulars shall be deemed to be a statement that the property is in good structural condition or otherwise, nor that any of the services, appliances, equipment or facilities are in good working order or have been tested. Purchasers should satisfy themselves on such matters prior to purchase Ref.W04990

Wonderful Field View



Large Lounge with Field Views



Pitch Fee: approx £219.36 per month
Subject to Annual Review
Council Tax band: 'A'

Tenure: 1983 Mobile Homes Act Agreement

The recommended specialist in Park Home sales
Proprietor: Simon Dixon

